

SAFETY KNIFE SECUMAX 350

ORDER NOW!

Order No.	350001.02
Knife size (L x W x H)	154 x 12 x 40 mm
Weight knife	37.0 g
Basic material	Glass fibre reinforced plastic



MAXIMUM
SAFETY

Innovative 2-in1 blade head
for cutting and splitting

Light ergonomic handle
(incl. soft grip)
for right and left handers

Blade change button
incl. access to spare
blade head

6 mm cutting depth
for all common cutting
materials



Concealed blade
for maximum protection of
users and goods

Practical eyelet
for a secure
attachment

2-cutting edge blade
for a double period of use

THE SAFER WAY TO CUT.

martor

MARTOR SAFETY KNIFE SECUMAX 350

SAFETY TECHNOLOGY



SECUMAX
= maximum safety

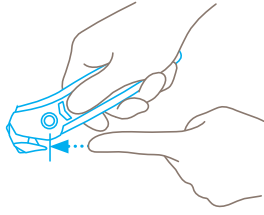

Concealed blade

The SECUMAX 350 blade is not an open one, but is hidden from people and goods. This provides you with a maximum degree of safety from cut injuries and from damage to goods.

TECHNICAL FEATURES



Tool-less blade change



Abrasion resistant



Very ergonomic



2-cutting edge blade



1 spare blade in knife body



Cutting depth



Tape splitter



Soft grip



For right and left handers



Lanyard hole



Printable for promotional purposes

EXAMPLES OF USE



MAIN CUTTING MATERIALS



Cardboard: up to 2-ply



Wrapping, stretch and shrink foil



Tape



Plastic strapping band



Bagged goods



Layers of foil or paper



Yarn, cord



Felt

MOUNTABLE BLADES



SECUMAX BLADE NO. 3550
0.30 mm, 10 in box

NO. 3550.20

PACKING INFORMATION

Packaging unit	1 in single unit box (10 knives in multipack)
Size Single unit box	156.5 x 16 x 42 mm
Weight single unit box	50.0 g
EAN Code single unit box	4002632920820
Size outer pack	88 x 80 x 162 mm
Weight outer pack	560.0 g
EAN Code outer pack	4002632972140